

SER. RELIGIOSI - CAPPELLA



RIABILITAZIONE



CARDIOLOGIA RIABILITATIVA

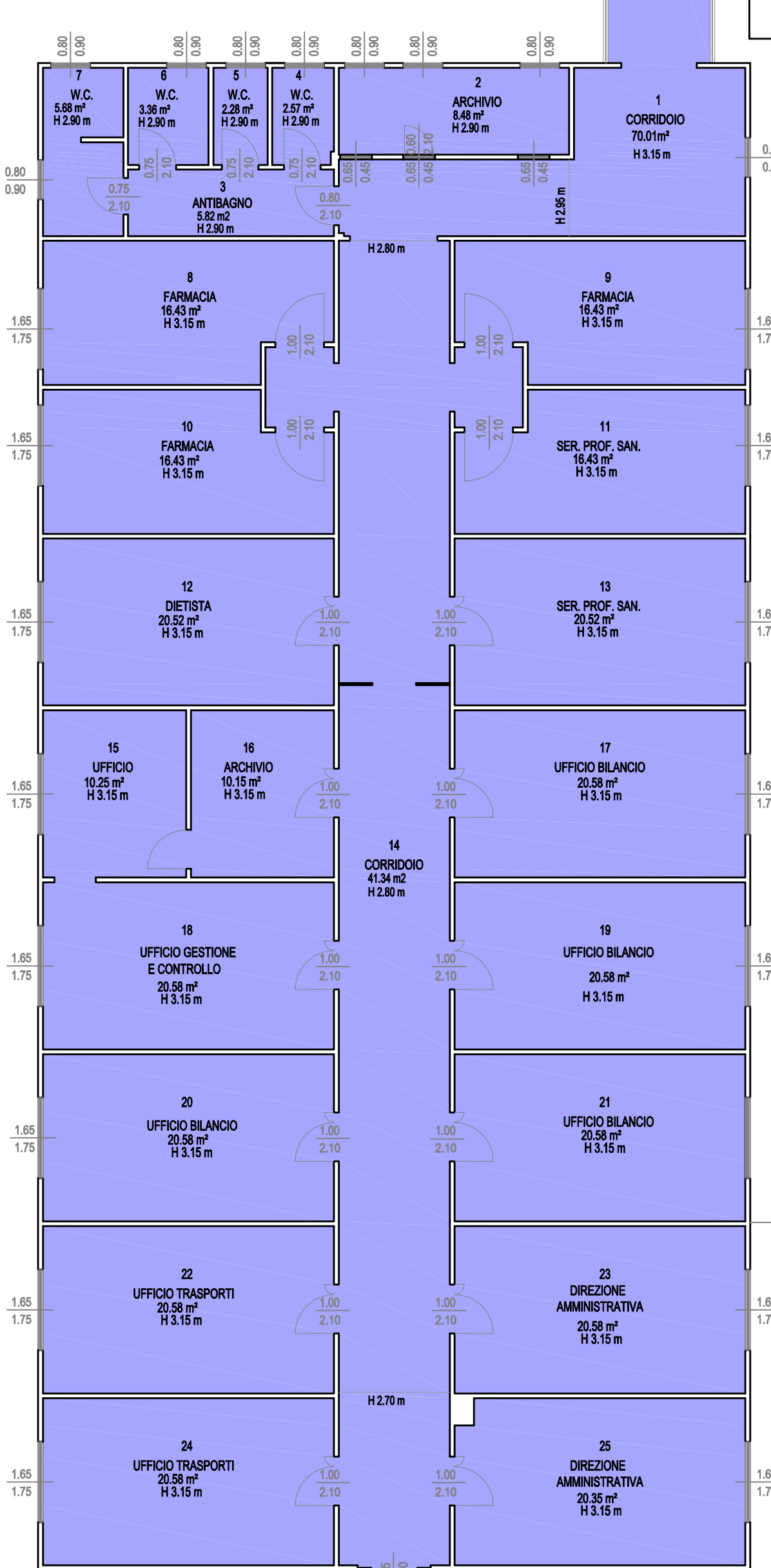

ONCOLOGIA



UFFICI



AMBULATORI CARDIOLOGIA



SALA GESSI



TRIB. DIRITTI D. MALATO



AREA CANTIERE NUOVA DIALISI



OSTETRICIA



EX GINECOLOGIA



AREA CANTIERE NUOVA DIALISI

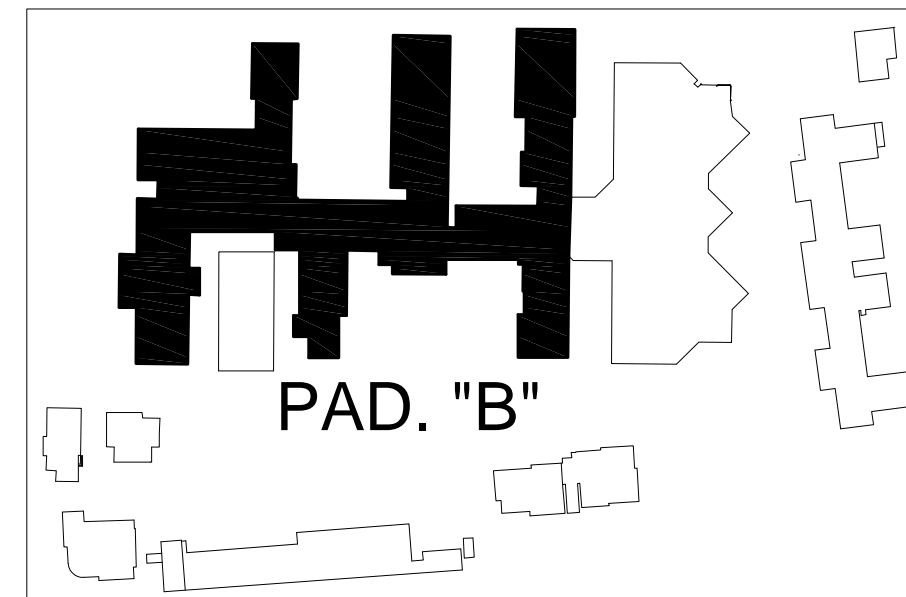

PAD. "B"

